

JULEP

619-754-4041

EVENTS@JULEPVENUE.COM

JULEPVENUE.COM

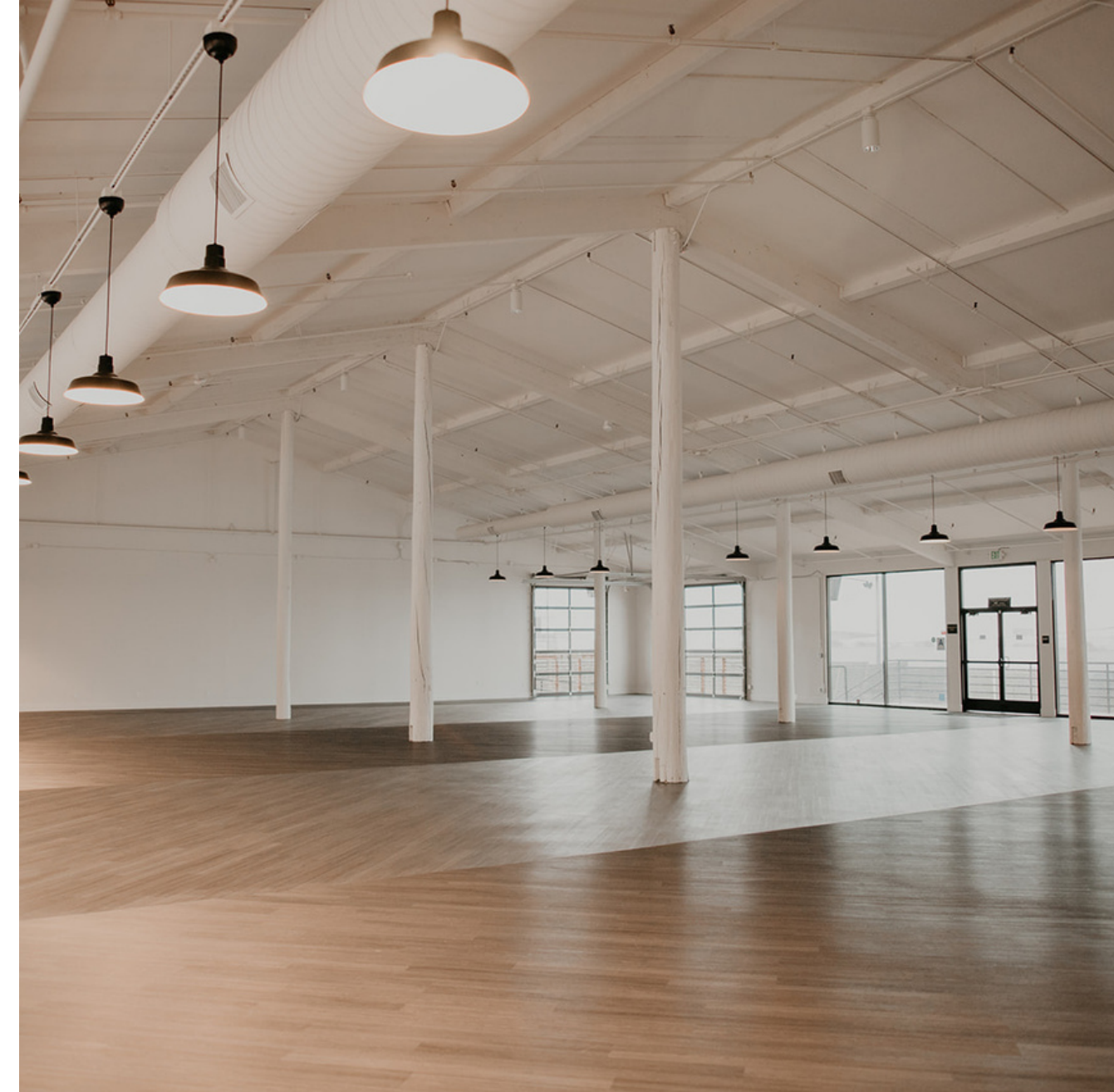

10 Hours of Venue Access
Up to 30 - 60" Round Tables
Up to 20 - 6' or 8' Tables
Up to 20 Cocktail Tables
Up to 250 White Resin Chairs
Up to 20 Tablecloths
1 Security Guard for 6 Hours
Standard Cleaning
On-Site Parking
Portable Heaters

WEEKEND FULL VENUE BUYOUT

ESTIMATED SEATED CAPACITY: 350

ESTIMATED COCKTAIL STYLE: 700

Capacities will change based on the nature of your event needs.

7 Hours of Venue Access
Up to 10 - 60" Round Tables
Up to 10 - 6' or 8' Tables
Up to 10 Cocktail Tables
Up to 5 Bistro Table Sets
Up to 100 White Resin Chairs
Up to 10 Tablecloths
Standard Cleaning
On-Site Parking
Portable Heaters

WEEKEND
COURTYARD +
PATIO + BAR
BUYOUT

ESTIMATED SEATED CAPACITY: 100
ESTIMATED COCKTAIL STYLE: 250

Capacities will change based on the nature of your event needs. You may also add on half of the main hall for an additional fee.



ABOUT JULEP

12,000SF OF INDOOR + OUTDOOR EVENT SPACE

Located in the base of Mission Hills, JULEP venue is one of the few event spaces in San Diego that provides tables, chairs, linens, bar service, on-site parking, and many more services and amenities that are essential for every event.

JULEP is perfect for large corporate events that require All-Inclusive Packages and ample space for seating and parking. JULEP is also favored amongst Wedding Planners for its bright and airy feel and the flow between the indoor and outdoor spaces.

THE JULEP VIBE

With fresh white walls, exposed ceilings, industrial pendant lights, and custom built-ins, JULEP offers an elevated design experience and maximum flexibility to customize your layout to fit your event needs.

Our outdoor event spaces are adorned with bistro lighting, built in seating, and large potted plants, giving the space warmth and texture. Our 650sf bar area has a Parisian cafe vibe and connects to the patio, main hall, and courtyard.



JULEP FLOOR PLAN

Our Event Coordinators will work directly with you and your Event Planner to design the ideal floor plan for your event. With 12,000 square feet of indoor-outdoor event space, Julep is the perfect spot for large corporate events and festivals. With our custom dividers, our Main Hall can be as small and cozy as you need it to be. We'll be happy to show you how to create magic from a blank canvas!

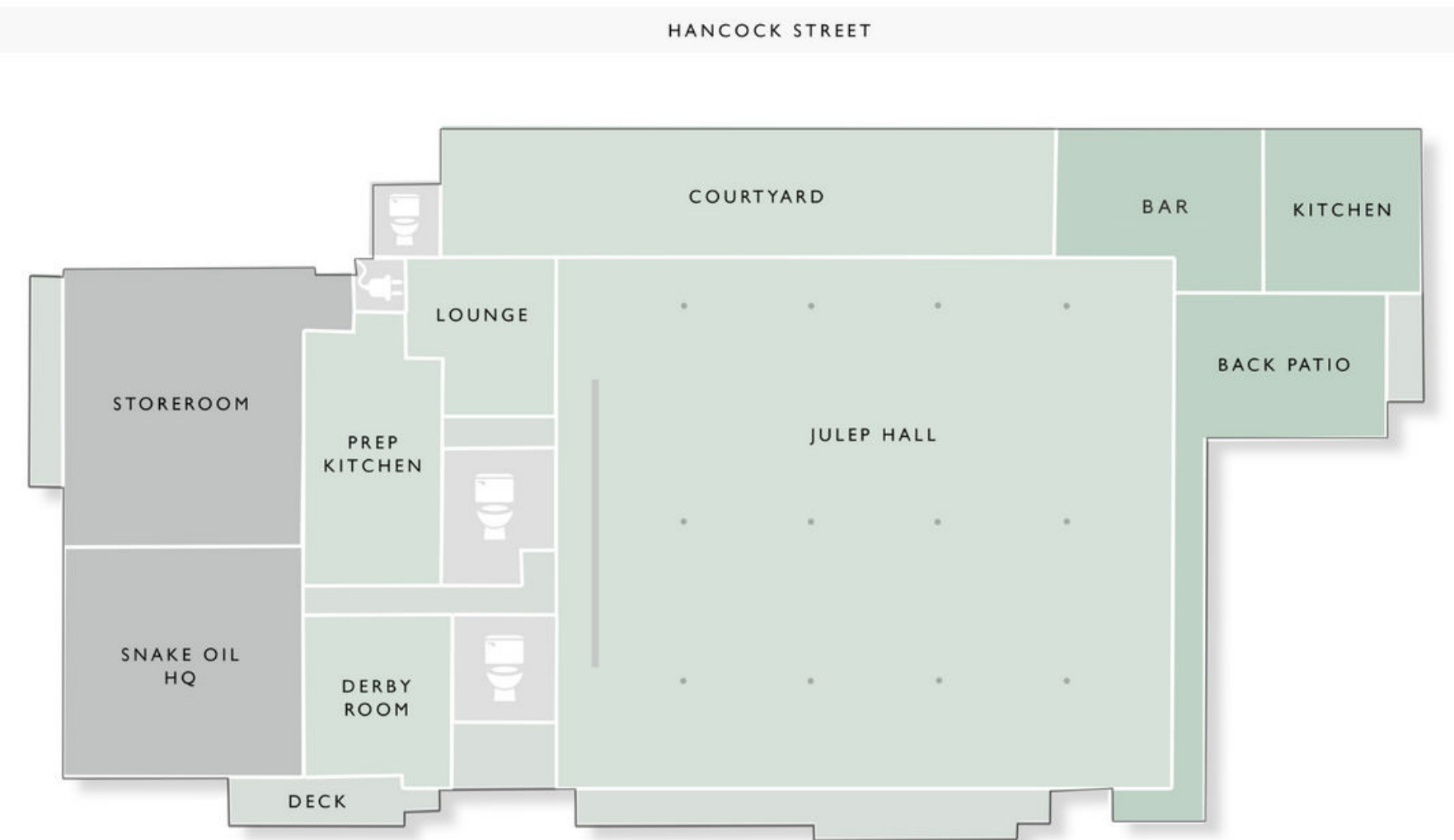

LET'S CONNECT

[BOOK A TOUR HERE](#)

[BOOK A CALL HERE](#)

619-754-4041
EVENTS@JULEPVENUE.COM
JULEPVENUE.COM



INSTAGRAM

@JULEPVENUE

FACEBOOK

@JULEPVENUE

WEBSITE

JULEPVENUE.COM